

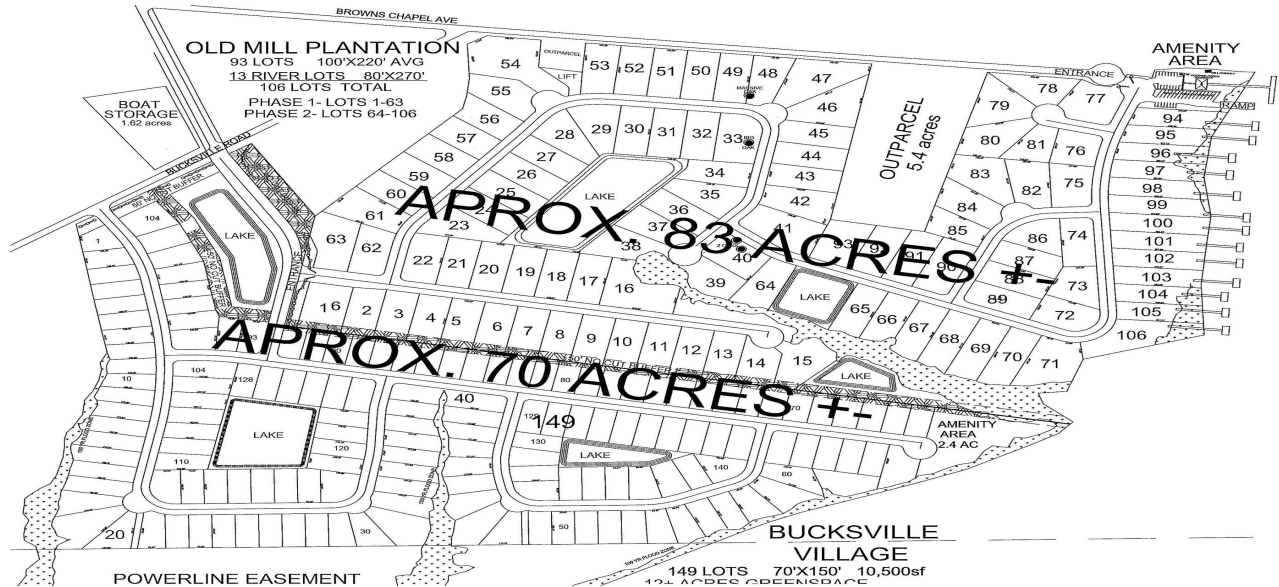

# TBD Old Bucksville Rd., Conway, 29527, SC

[https://searchrealestate.co/properties/tbd-old-bucksville-rd/conway/sc/29527/MLS\\_ID\\_2427445](https://searchrealestate.co/properties/tbd-old-bucksville-rd/conway/sc/29527/MLS_ID_2427445)



**Price - \$5,900,000**

**Lot Size    DOM**

162.3200    177 Days

## Features

### Lot Features

- Irregular Lot
- Acreage

### Other

- River Front
- River Access

## Description

**Property Overview:** Size: Approximately 162 acres. Development Potential: Proposed 255 homesites. Location: Riverfront property with direct access to the Intracoastal Waterway. Property Highlights: Pristine Riverfront Setting: This expansive tract boasts high ground along the river, rolling terrain, fertile soils, and mature trees, offering an idyllic setting for a residential community. Natural Privacy: Flanked by federal wildlife preserves on both sides, the property ensures enduring privacy and natural beauty for future residents. Historical Significance: The site includes remnants of one of Horry County's original sawmills, featuring a brick chimney that could serve as a unique focal point in community planning. Development Potential Proposed Layout: Envisioned for 255 residential lots, this property is situated in a rapidly developing area just outside Conway, SC, making it a prime candidate for a new riverfront community. Water & Sewer are available on Old Bucksville Rd. Accessibility: The property's river frontage provides easy access to the Intracoastal Waterway, enhancing its appeal for water enthusiasts and adding significant value to the development potential. Location Benefits: Proximity to Conway: Located just outside the city limits of Conway, residents will enjoy a blend of serene riverfront living with convenient access to urban amenities. Natural Surroundings: The adjacent national wildlife refuges offer opportunities for outdoor recreation and ensure the preservation of the area's natural landscape. Regional Growth and Development: Population Growth: Horry County has experienced substantial growth over the past decades. The population increased from 270,295 in 2010 to an estimated 397,478 in 2023, marking a growth of approximately 47% over 13 years. Domestic Migration: Horry County, South Carolina, has experienced significant population growth in recent years. Between July 1, 2022, and July 1, 2023, the county attracted over 15,000 new residents through domestic migration, ranking it 10th in the nation for that period. This influx reflects a broader trend, as the county's population has grown by approximately 57.66% since 2010, reaching an estimated 426,140 residents in 2025. Additionally, Myrtle Beach, located within Horry County, has been recognized as the fastest-growing city in the United States for 2023. Local Developments: The area surrounding Old Bucksville Road is witnessing notable residential development. Broader Development Trends: Conway and its neighboring communities are experiencing a surge in new construction projects, reflecting the county's overall growth and the increasing demand for housing in the area.

## SEE THIS PROPERTY



### James Schiller

Realtor, Brand Name Real Estate

Phone: 18434788061

Email: jameseschiller@gmail.com

### Check On Site



[https://searchrealestate.co/properties/tbd-old-bucksville-rd/conway/sc/29527/MLS\\_ID\\_2427445](https://searchrealestate.co/properties/tbd-old-bucksville-rd/conway/sc/29527/MLS_ID_2427445)

### Location

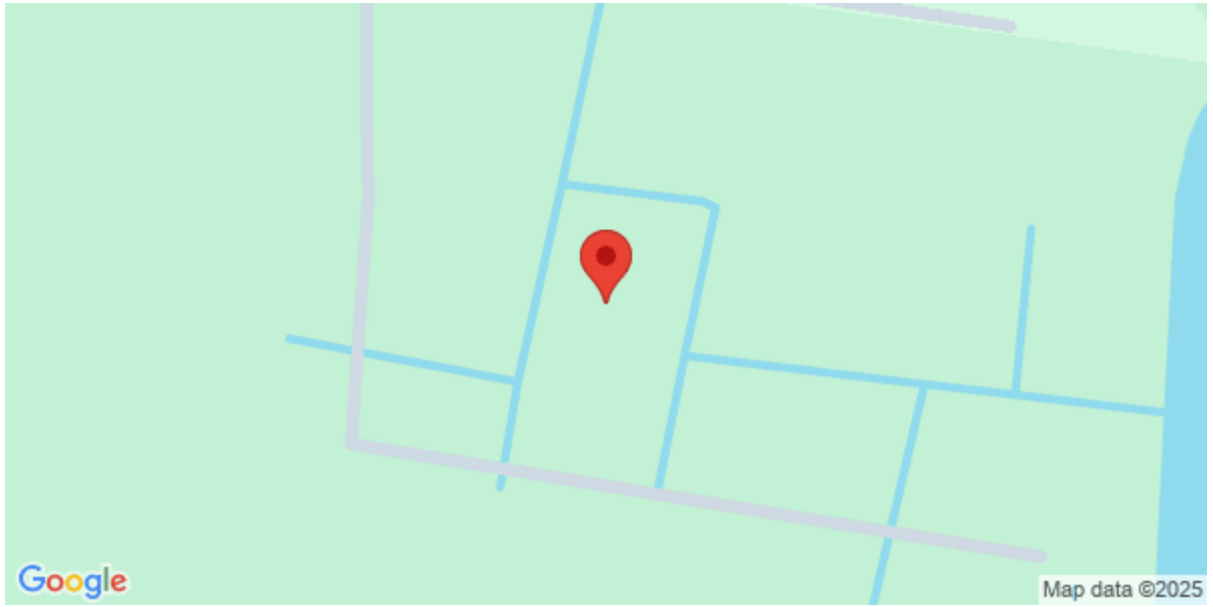

TBD Old Bucksville Rd., Conway, 29527, SC